

Nominate a Heritage Asset

Southbourne Parish Neighbourhood Plan Pre-Submission Modified Plan
Local Heritage Assets (SB9.EV6)

(September 2022)

No. 9 The Green Ring Gateway and Seating, Parham Place, Main Road, Southbourne, PO10 8FS

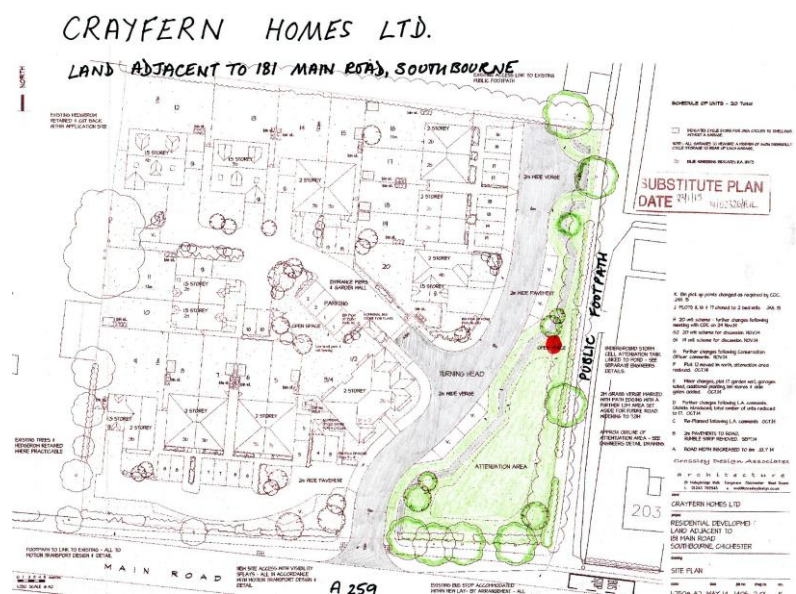
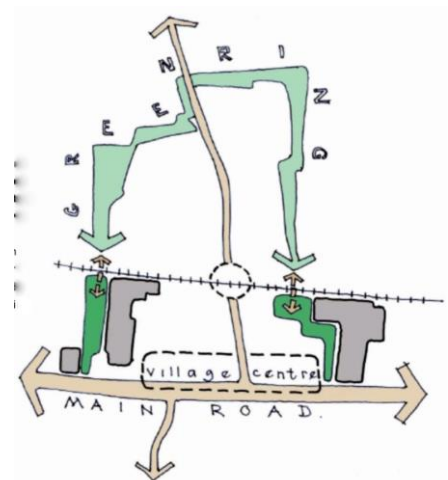

The Green Ring was included in our Southbourne Parish Neighbourhood Plan 2015. In 2016 the gateway and seating was included in the development at Parham Place.

Nominate a Heritage Asset

1. WHAT IS IT? Is it one of the following?	Tick
a building or group of buildings	
a monument or site (an area of archaeological remains or a structure other than a building)	√
a place (e.g. a street, park, garden or natural space)	
a landscape (an area defined by visual features or character, e.g. a city centre, village, suburb or field system)	

2. WHY IS IT INTERESTING? Is it interesting in any of the following ways?	Tick / Rank
Historic interest – a well documented association with a person, event, episode of history, or local industry	
Archaeological interest – firm evidence of potential to reveal more about the human past through further study	
Architectural interest – an example of an architectural style, a building of particular use, a technique of building, or use of materials	
Artistic interest – It includes artistic endeavour to communicate meaning or use of design (including landscape design) to enhance appearance	√
What is it about the asset that provides this interest? The arch was commissioned from the Amberly blacksmith as a piece of artwork to mark the entry to the Southbourne Green Ring. The seating was put in place to encourage the public, especially adults with children, to stop and enjoy the green space.	

3. WHY IS IT LOCALLY VALUED? Is the interest of the asset valued locally for any of the following reasons?	Tick / Rank
Association: It connects us to people and events that shaped the identity or character of the area	√ 1
Illustration: It illustrates an aspect of the area's past that makes an important contribution to its identity or character	
Evidence: It is an important resource for understanding and learning about the area's history	
Aesthetics: It makes an important contribution to the positive look of the area either by design or fortuitously	
Communal: It is important to the identity, cohesion, spiritual life or memory of all or part of the community	√ 2
How is the asset locally valued as heritage? The artworks mark the first piece of Green Space purpose designed and dedicated to the Southbourne Green Ring. It is an ambitious project that will take many years to complete but this was an important start. The community welcomed this project when it was inaugurated in the first Southbourne Parish Neighbourhood Plan 2015.	

4. WHAT MAKES ITS LOCAL SIGNIFICANCE SPECIAL? Do any of the following features make the heritage significance of the asset stand out above the surrounding environment?	Tick
Age ... Is it particularly old, or of a date that is significant to the local area?	
Rarity ... Is it unusual in the area or a rare survival of something that was once common?	
Integrity ... Is it largely complete or in a near to original condition?	
Group value ... Is it part of a group that have a close historic, aesthetic or communal association?	
Southbourne's identity ... Is it important to the identity or character of the city or a particular part of it? How does this contribute to its value? Significant structures erected in 2016 marking the start of the Green Ring, a community long term aspiration.	√